

SPECIFICATIONS

Material: HEXSEALS: Silicone rubber conforms to A-A-59588 Class 3, GR 60 unless otherwise specified.

Mounting Nut: HEXSEALS: Brass, nickel-plated (unless otherwise noted)

Temperature Range: HEXSEALS: -94°F to +400°F

Pressure Range: Exceeds 15 psi internal and 1500 psi external.

Operational Life: 50,000 actuations (minimum).

Shelf Life: Excess of 25 years.

Resistant to: Salt spray, sunlight, ozone, weather, fungus, and most acids and lubricating oils

Agency Recognition: E-SEELS and HEXSEALS are UL-listed to UL Std. 50 types 1-13, and meet CSA standards.

Installation: If a reducing adaptor is required - see page 14 of HEXSEAL catalog HEX200 for part numbers and drawing.

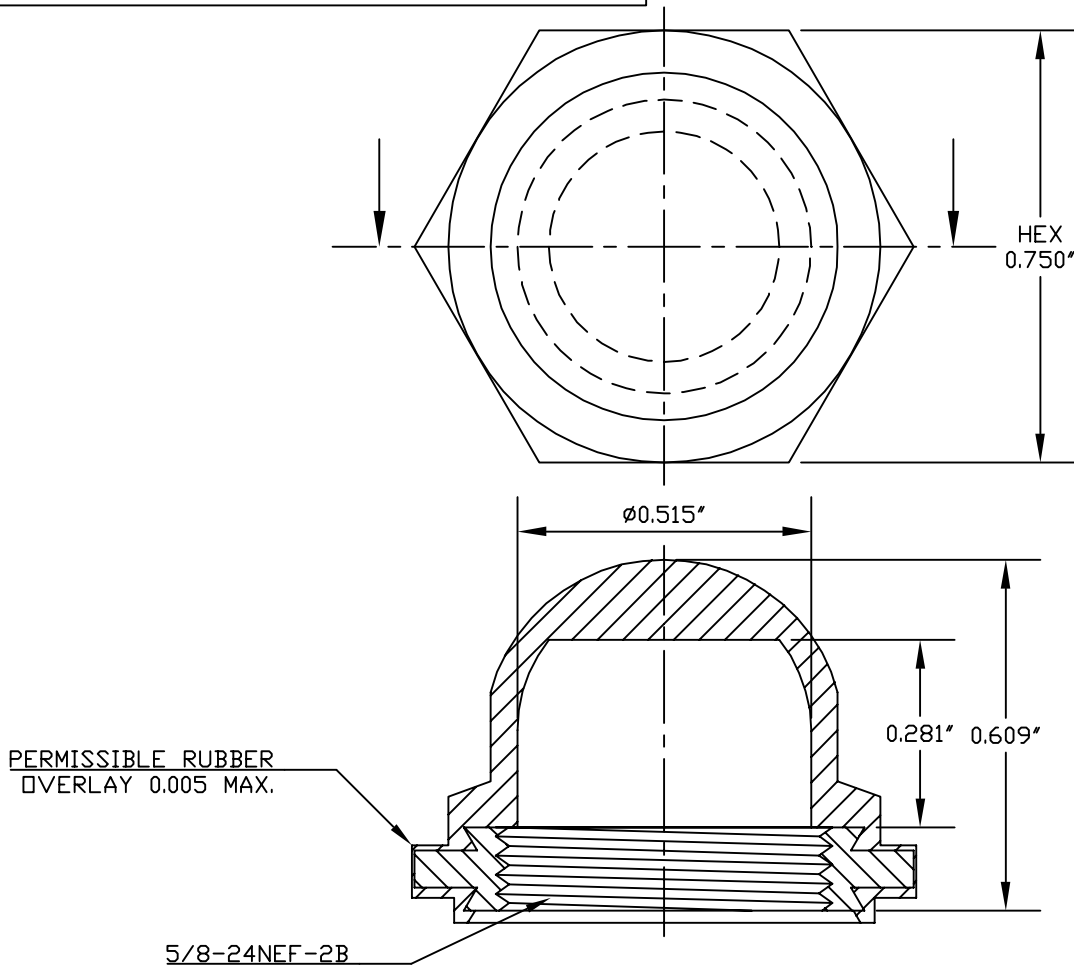

| | | | |
|---|--|--------------------|----------------------------|
| J | MAT'L CHANGED and REDRAWN | S. GOK | 06.16.09 |
| I | CAD COMPUTER GENERATED | | 09.23.02 |
| H | UPDATED, ADDED ORDER NUMBERS, DWG. NO. WAS 1231/SERIES | W. P. | 11.24.76 |
| REV. | DESCRIPTION | | DATE |
| MAXIMUM AND MINIMUM MEASUREMENTS ARE STATED DIRECTLY ON EACH DIMENSION. | TITLE: BOOT, PUSH BUTTON SWITCH (N3040) | ENG. M. MORSE | 01.21.60 |
| MAT'L: Silicone Rubber A-A-59588, Gr.60 | | DWN. S. ANDREWS | 01.21.60 |
| | | CHKD. B. GLICKSMAN | 01.21.60 |
| FINISH: GRAY | APM-HEXSEAL CORPORATION | SCALE 3 : 1 | DWG. NO. (N3040) HEXSEAL ® |

THIS DRAWING COVERS PROPRIETARY ITEM AND IS THE PROPERTY OF THE APM-HEXSEAL CORPORATION.
THIS DRAWING IS NOT TO BE COPIED OR USED WITHOUT THE WRITTEN APPROVAL OF AN OFFICER OF THE APM-HEXSEAL CORPORATION.