

### SPECIFICATIONS

**Material:** HEXSEALS: Silicone rubber conforms to A-A-59588 Class III, GR 60 (unless otherwise specified)

**Mounting Nut:** HEXSEALS: Brass, nickel-plated

**Temperature Range:** HEXSEALS: -94°F to +400°F

**Pressure Range:** Exceeds 15 psi internal and 1500 psi external.  
(N5032B: 10 psi)

**Operational Life:** 50,000 actuations (minimum).

**Shelf Life:** Excess of 25 years.

**Resistant to:** Salt spray, sunlight, ozone, weather, fungus, and most acids and lubricating oils

**Agency Recognition:** E-SEELS and HEXSEALS are UL-listed to UL Std. 50 types 1-13, and meet CSA standards.

**Installation:** If a reducing adaptor is required - see page 14 of HEXSEAL catalog HEX200 for part numbers and drawing.

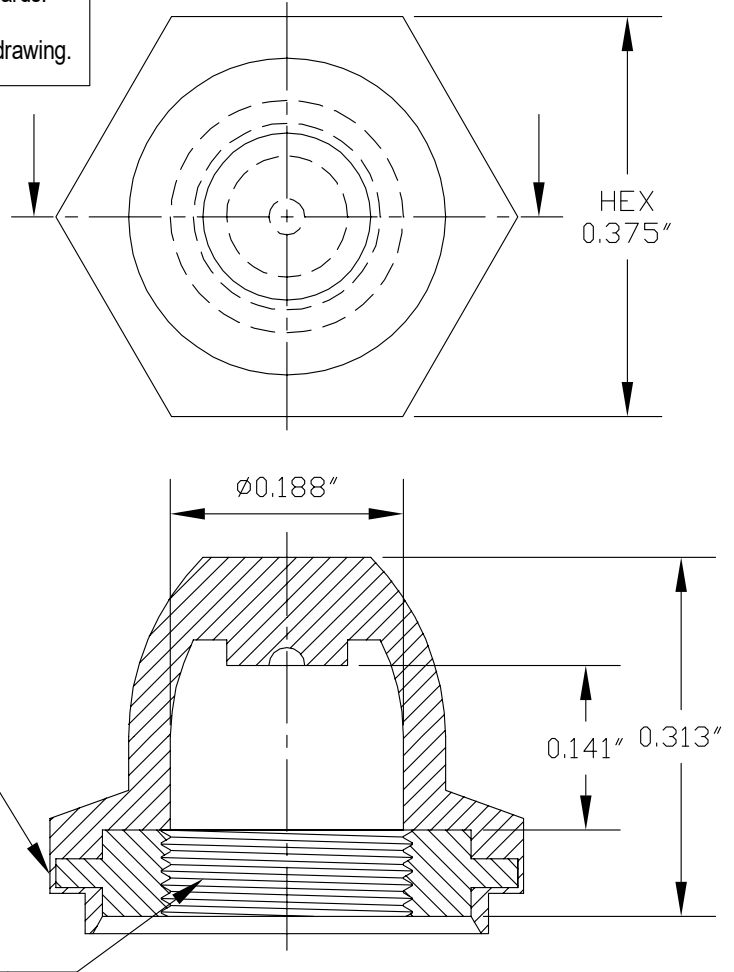

| J   | MAT'L CHANGED and REDRAWN FOR ACCURACY                 | S. GOK   | 06.26.09              |
|---|--|----------|-----------------------|
| I   | CAD COMPUTER GENERATED                                 |          | 09.23.02              |
| H   | UPDATED, ADDED ORDER NUMBERS, DWG. NO. WAS 1231/SERIES | W. P.    | 11.24.76              |
| G   | UPDATED  | R. C.    | 08.04.74              |
| F   | REDRAWN  | TONY C.  | 12.11.69              |
| REV.  | DESCRIPTION  | DATE     |                       |
| MAXIMUM AND MINIMUM MEASUREMENTS ARE STATED DIRECTLY ON EACH DIMENSION. |  | ENG.     | M. MORSE 01.21.60     |
| MAT'L: SILICONE RUBBER  |  | DWN.     | S. ANDREWS 01.21.60   |
| PER A-A-59588 CL III GR60   |  | CHKD.    | B. GLICKSMAN 01.21.60 |
| FINISH: GRAY  |  | SCALE    | (N-5040)              |
|   |  | 6 : 1    | HEXSEAL ®             |
| APM-HEXSEAL CORPORATION   |  | DWG. NO. |                       |

THIS DRAWING COVERS PROPRIETARY ITEM AND IS THE PROPERTY OF THE APM-HEXSEAL CORPORATION.  
THIS DRAWING IS NOT TO BE COPIED OR USED WITHOUT THE WRITTEN APPROVAL OF AN OFFICER OF THE APM-HEXSEAL CORPORATION.